

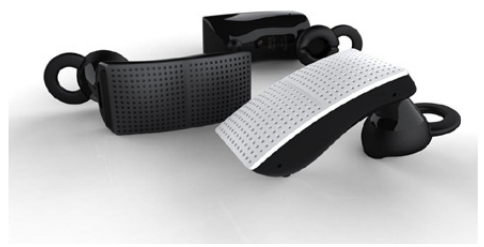

QUICK START



Jawbone ICON

- 1 Jawbone ICON Anatomy
- 2 Get Comfortable
- 3 Get Connected
- 4 Talking Points
- 5 Power Up, Etc.
- 6 Safety Information

Note For best results, print on 8.5 x 14” (legal-sized) paper.

1 Jawbone ICON Anatomy

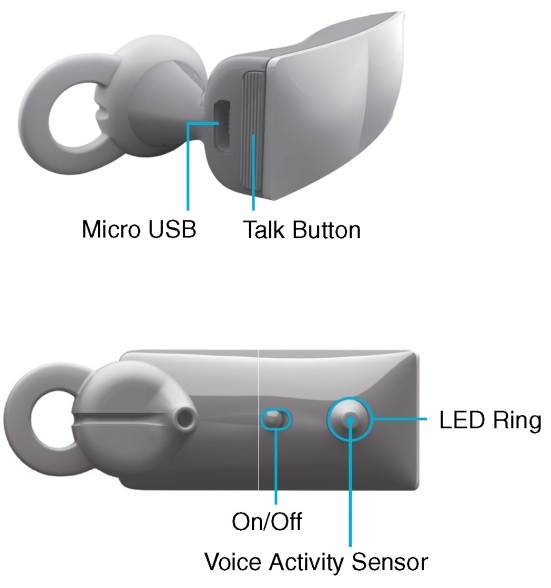

Features

Your Jawbone ICON is equipped with advanced technology. Here are some features to enjoy.

NoiseAssassin 2.5

With wind reduction.

Simultaneous Multipoint

Allows you to manage two calls from two different phones at the same time.

Custom Audio Tones

Convey caller ID, remaining battery life and more.

Battery Meter for iPhone

MyTalk (mytalk.jawbone.com)

Allows you to personalize and update Jawbone ICON via the web.

2 Get Comfortable

Find Your Fit

Mix and match to select the most comfortable and secure fit option.

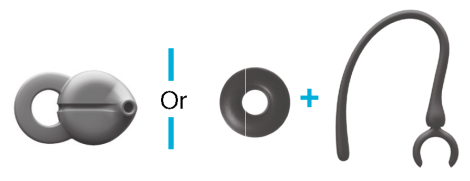

Jawbone ICON can be worn **with** or **without** an earloop.

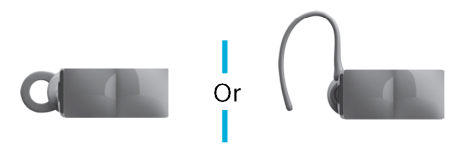

Drop, Twist, & Point

For the most secure fit, place your Jawbone ICON in your ear pointing down.

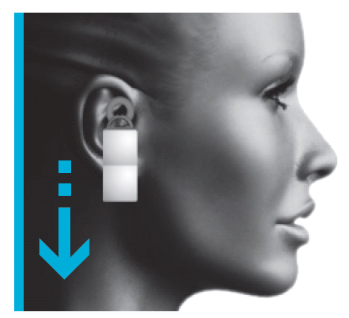

Then, twist it upwards so it points directly at your mouth.



Ensure Best Quality

Jawbone ICON works regardless of position, but you will get the best performance if the Voice Activity Sensory physically touches your cheek.

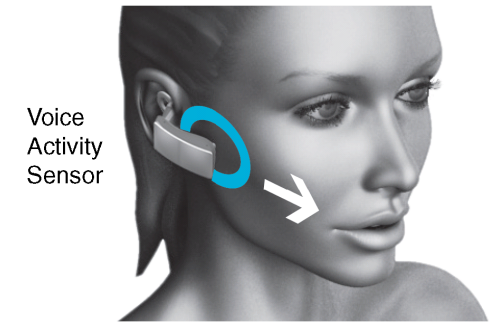

Americas Headquarters
 Cisco Systems, Inc.
 170 West Tasman Drive
 San Jose, CA 95134-1706
 USA
<http://www.cisco.com>
 Tel: 408 526-4000
 800 553-NETS (6387)
 Fax: 408 527-0883



Cisco and the Cisco Logo are trademarks of Cisco Systems, Inc. and/or its affiliates in the U.S. and other countries. A listing of Cisco's trademarks can be found at www.cisco.com/go/trademarks. Third party trademarks mentioned are the property of their respective owners. The use of the word partner does not imply a partnership relationship between Cisco and any other company. (1005R)

© 2010 Cisco Systems, Inc. All rights reserved.

3 Get Connected

Prepare Your Jawbone ICON

Press and hold the **Talk Button** while sliding on your Jawbone ICON until the LED flashes **Red+White**. This indicates that the Jawbone ICON is ready to connect (paring mode).

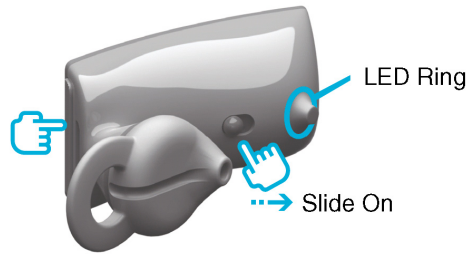

Prepare Your Phone

Turn on the Bluetooth settings.

On a Bluetooth-Enabled Cisco Unified IP Phone

Review the User Guide for your IP phone if the Jawbone ICON headset and IP phone are not already connected.

On an iPhone

Go to **Settings > General** and enable **Bluetooth**.

On a Blackberry

Go to **Settings/Options > Bluetooth** and enable **Bluetooth**.

Other Cell Phones

Go to jawbone.com/paring or review the instruction manual that came with your phone.

Make the Connection

Go to your phone's Bluetooth settings.

Add or Search for Devices

When "Jawbone ICON for Cisco" appears, select it.

If asked for a passcode, enter "0000".

This is a one-time event you should now have to repeat, unless you are connecting your Jawbone ICON headset to another phone.

4 Talking Points

Answer/End a Call

Press the **Talk Button** on your Jawbone ICON to both answer and end a call.

Decline an Incoming Call

Hold the **Talk Button** for 2 seconds.

Make a Call

Use your phone to dial as usual. Listen and talk through your Jawbone ICON.

Activate Voice Dialing

Hold the **Talk Button** until you hear a beep and then release.

Redial Last Number

Press the **Talk Button** twice.

Simultaneous Calls

To switch between calls, press the **Talk Button**. To end one call and switch to the other, press the **Talk Button** twice.

Adjust the Volume

Press and hold the **Talk Button** and the volume level will cycle up and down. When you find the most comfortable volume level, release the button and your volume will be set. Or just use the volume control on your phone.

Mute a Call

Use your phone to place a call on mute.

5 Power Up, Etc.

Get Juiced

Your Jawbone ICON is partial charged and ready for use right out of the box.



To Hear Remaining Battery Life

Press the **Talk Button** when not on a call.

When Battery is Low

The LED indicator flashes **Red**.

For a Full Charge

Plug it in.

When Fully Charged

The LED indicator turns **White**.



Note

It takes 40 minutes to get your Jawbone ICON 80% charged. A full charge takes 90 minutes.

Tech Specs

- **Talk Time:** Up to 4.5 hours
- **Standby:** More than 10 days
- **Range:** 33 feet (10 meters)
- Micro-USB standard connector interface
- Bluetooth 2.1 +_ EDR
- Packaging 100% recyclable



Tip

To avoid potential interference issues between Bluetooth headsets and other wireless devices, use the Cisco Unified IP phone on the same side of your body as the headset.

6 Safety Information

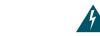

Warning

Failure to follow these safety instructions could result in hearing damage, or in fire, electric shock, or other injury or damage.

Avoiding Hearing Damage

Permanent hearing loss may occur if the Jawbone ICON headset is used at a high volume. Set the volume to a safe level. Even though you may become accustomed to a higher volume of sound, and even though it may sound normal, any higher volume of sound can be damaging to your hearing. If you experience ringing in your ears or muffled speech, stop listening and have your hearing checked. The louder the volume, the less time is required before your hearing could be affected.

The Jawbone ICON headset has been initially set at a medium volume for sound. Do not increase the level of volume unless you are in conditions where you need a higher level for a short period of time. If this level of volume is uncomfortably high for you, you should decrease this level.

Hearing Experts Suggest That to Protect Your Hearing:

1. Limit the amount of time you use the Jawbone ICON headset including use at high volume.
2. Avoid turning up the volume to block out noisy surroundings.
3. Turn the volume down if you can't hear people speaking near you.

Jawbone ICON Headset Care

- Do not expose your Jawbone ICON headset to liquid, moisture, humidity, or rain. The Jawbone ICON headset is not waterproof.
- Do not tamper with or abuse the Jawbone ICON headset. For example, without limitation, do not drop, disassemble, open, crush, bend, deform, puncture, shred, microwave, incinerate, paint, or insert foreign objects into the Jawbone ICON headset.
- Do not use abrasive cleaners to clean your Jawbone ICON headset.
- Do not expose your Jawbone ICON headset to extremely high or low temperatures.
- Do not leave your Jawbone ICON headset in direct sunlight for an extended period of time.
- Do not leave your Jawbone ICON headset near open flames such as cooking burners.
- Do not dispose of your Jawbone ICON headset in a fire. The battery could explode.
- Do not bring your Jawbone ICON headset into contact with any sharp objects. This can cause scratches and damage.

- Do not insert anything into your Jawbone ICON headset unless otherwise specified in the user manual. This may damage the internal components.
- Do not attempt to disassemble your Jawbone ICON headset, it does not contain serviceable components.
- Do not wear your Jawbone ICON headset without an AliphCom approved earbud.

Built-In Battery Care

- Do not attempt to replace your Jawbone ICON headset's battery. It is built-in and not changeable.
- Charge the battery in accordance with the instructions supplied with this guide.
- Use only the charger supplied by Jawbone ICON headset's original manufacturer to charge the battery.

Charger Care

- Use only the chargers supplied by the Jawbone ICON headset's original manufacturer to charge your Jawbone ICON headset. Other chargers may look similar but using them could be dangerous and could damage the Jawbone ICON headset.
- Do not attempt to disassemble the charger as it may expose you to dangerous electric shock.
- Do not use the charger outdoors or in damp areas.
- Only charge your Jawbone ICON headset's built-in battery in accordance with the instructions described in this guide.
- Avoid charging your Jawbone ICON headset in extremely high or low temperatures.
- Do not use your Jawbone ICON headset while it is charging.
- Do not connect the Jawbone ICON headset to the charger while on an active call.

Safety Information

- Check and observe local laws regarding the use of a mobile phone and headset while driving. If you use the Jawbone ICON headset while driving, ensure that you maintain your full attention and focus; it is your responsibility to drive safely. Consider pulling off the road before making or answering a call.
- Never allow children to play with the Jawbone ICON headset; the small components of the headset may be a choking hazard.
- Do not leave or store the Jawbone ICON headset or any of its accessories in the area over the air bag or in the air bag deployment area of an automobile as serious injury may result when an air bag deploys.
- Observe all signs and displays that require an electrical device or RF radio product to be switched off in designated areas.
- Turn off your Jawbone ICON headset prior to boarding aircraft. Do not use the Jawbone ICON headset inside an aircraft in flight unless allowed by your airline.
- Never use the Jawbone ICON headset while taking a bath.
- Do not use the Jawbone ICON headset in a sauna or steam room.
- Do not keep your Jawbone ICON headset near a sink or other wet areas.
- Do not clean your Jawbone ICON headset while it is being charged. Always unplug the charger first before cleaning the Jawbone ICON headset.
- Do not attempt to repair or modify the Jawbone ICON headset yourself. The Jawbone ICON headset does not contain any user-serviceable parts. If the Jawbone ICON headset has been submerged in water, punctured, or subjected to a severe fall, do not use it until you take it back to your original place of purchase.
- Do not attempt to force open the built-in battery.

- Dispose of the battery in the Jawbone ICON headset according to local regulations. Do not dispose of the battery with household waste.
- Disposal of the packaging and your Jawbone ICON headset should be done in accordance with local regulations.
- Do not leave the Jawbone ICON Car Charger in the car (cigarette lighter) port when the vehicle is off.
- Do not plug the Jawbone ICON Car Charger into the car (cigarette lighter) port until after you have started your vehicle.
- Do not clean your Jawbone ICON headset while it is being charged.
- Always unplug the charger first before cleaning the Jawbone ICON headset.
- Do not attempt to repair or modify the Jawbone ICON Car Charger yourself.
- The Jawbone ICON Car Charger does not contain any user-serviceable parts. If the Jawbone ICON Car Charger has been submerged in water, punctured, or subjected to a severe fall, or the blue LED shuts off during charging, discontinue use and replace.
- Do not attempt to force open the Jawbone ICON Car Charger.
- Disposal of the packaging and your Jawbone ICON Car Charger should be done in accordance with local regulations.
- The Jawbone ICON Car Charger may become uncomfortably hot to the touch. If you are sensitive to heat, please wait to remove the Jawbone ICON Car Charger from the car (cigarette lighter) port.

Other Notes

Packaging and Product Disposal

Dispose of the packaging and this product in accordance with the latest provisions.

FCC Compliance

This device complies with Part 15 of the FCC Rules. Operation is subject to the following two conditions:

- This device may not cause harmful interference, and
- This device must accept any interference received, including interference that may cause undesired operation.

Cautions

Changes or modifications not expressly approved by the party responsible for compliance could void the user's authority to operate the equipment.

FCC ID: V3J-JBG. IC: 7589A-JBG

To locate the FCC and IC identification numbers, remove the earbud from the Jawbone ICON headset.

Only use with the power supply adapter provided, Jawbone ICON model number SPA-K901.